



COLESGROVE MANOR  
HERTFORDSHIRE

**STATONS**  
[www.statons.com](http://www.statons.com)



# COLESGROVE MANOR

Colesgrove Manor is an impressive Grade II listed period property of architectural and historic interest. Privately gated and set in approximately 3.5 acres of established grounds with a detached Lodge House. Located in the village of Goffs Oak near Cuffley in South Hertfordshire.

The origins of the main house date back to 1629 and was built by Mr Warwick. Over the years the property has been sympathetically enlarged and has been the love of Richard Cromwell and the novelist Doris Leslie.

The flow of the house is charming and has been achieved by all the main rooms interconnecting.

Main rooms feature working fireplaces and the principal reception rooms have carved marble examples. The house enjoys a fully fitted Mark Wilkinson kitchen incorporating an Aga. In keeping with the style of the house a family room has been added with a hardwood conservatory.

North Lodge occupies its own grounds and is at the entrance of the gated property. It has been recently refurbished throughout and is completely independent from the main house. It is an attractive home in its own right, comprising an welcoming entrance hallway, main reception, kitchen, two bedrooms and a family bathroom.









## **EXTERNALLY**

The gardens and grounds are approximately 3.5 acres and have been established over many years featuring several varieties of Victorian and traditional trees adding to the splendour of the surrounding and also incorporates a heated swimming pool.

The main house is wrapped around with a Yorkstone paved terrace and approached via a gated entrance and sweeping driveway with feature water fountain.

There is a barn outbuilding providing two garages and large store area.

## **LOCATION**

Colesgrove Manor is tucked away in this picturesque setting on the outskirts of the village of Goffs Oak near Cuffley also around 5.5 miles east of Potters Bar and 8 miles south-west of Hertford. The area is surrounded by fine countryside yet is conveniently located for transport links and access to local amenities.

For commuting, there is a direct train service from Cheshunt to London Liverpool Street approximately 22 minutes. Cuffley and Potters Bar Stations are within easy reach. Road communications are also good with the A10 approximately 2 miles away, connection to Junction 25 of the M25 approximately 3 miles away, A1(M) and M11 are also within easy reach, offering excellent transport links to London and the North with easy access to major airports including Stansted, Luton and Heathrow.

Sporting facilities include golf at Hanbury Manor and Essendon Golf Club. Walking, riding and cycling are widely available and the Lee Valley Athletics Centre, the largest indoor and outdoor athletics facility in the south-east is just 4 miles away.

There are a wide range of excellent independent and state schools in the area including Haileybury College, Queenswood, Stormont School, Lochinver House, Richard Hale and Chancellors as well as many others.

















# COLESGROVE MANOR

EN7 5ND

Approximate Gross Internal Area  
 Cellar = 19.7 sq m / 212 sq ft  
 Ground Floor = 246.7 sq m / 2655 sq ft  
 First Floor = 133.5 sq m / 1437 sq ft  
 Second Floor = 91.5 sq m / 985 sq ft  
 The Lodge = 62.7 sq m / 675 sq ft  
 Garage = 65.9 sq m / 709 sq ft  
 Total = 620.0 sq m / 6673 sq ft

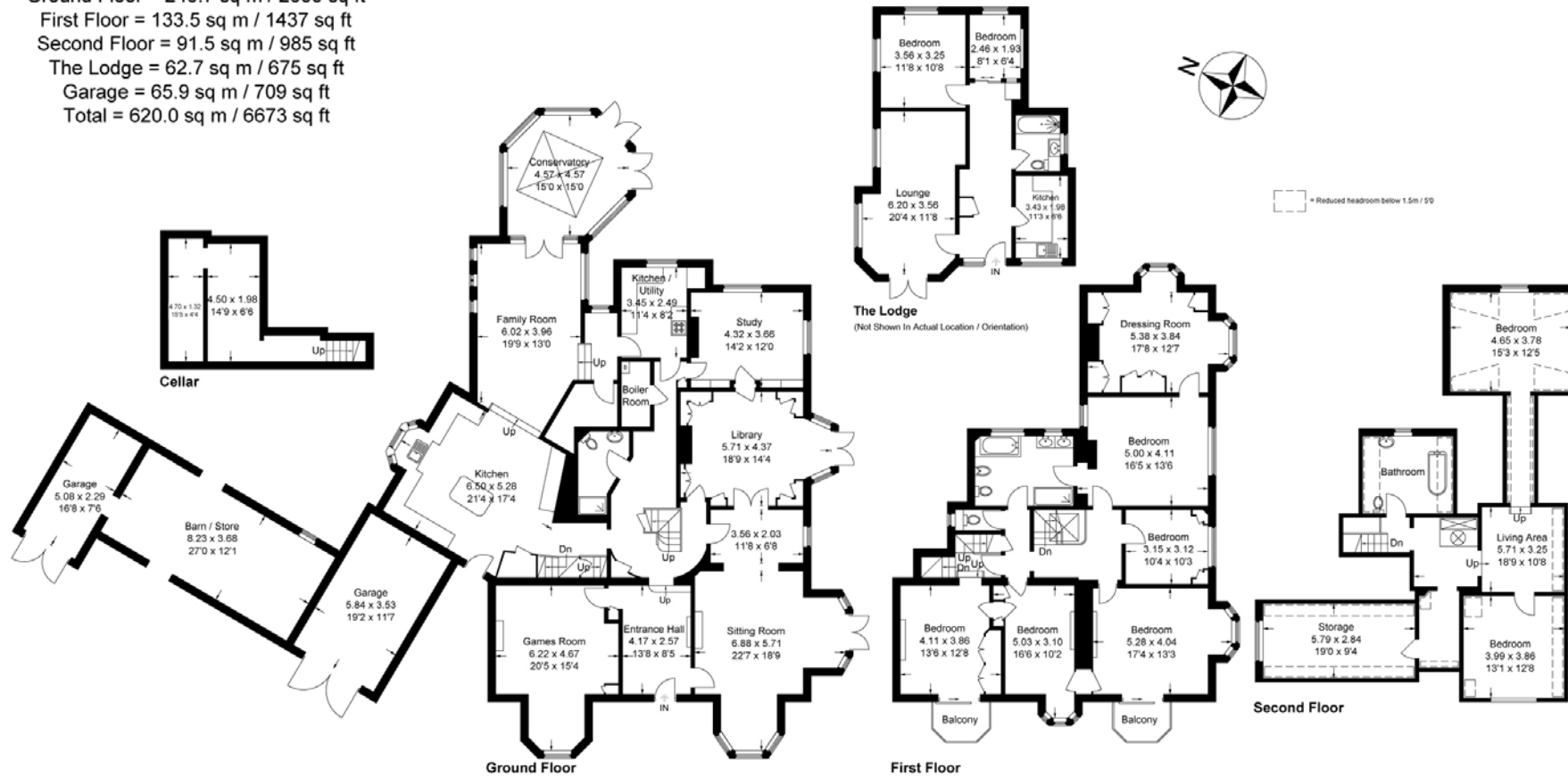

This plan is for layout guidance only. Not drawn to scale unless stated. Windows and door openings are approximate. Whilst every care is taken in the preparation of this plan, please check all dimensions, shapes and compass bearings before making any decisions reliant upon them.

© CJ Property Marketing Ltd Produced for Statons



53 Bradmore Green,  
 Brookmans Park, Hatfield,  
 AL9 7QS  
 brookmans@statons.com  
 www.statons.com  
 01707 661144

DISCLAIMER: As agents we have not tested any apparatus, equipment, fixtures, fittings or services, and so cannot verify that they are in working order or fit for the purpose. As a buyer you are advised to obtain verification from your Solicitor/Conveyancer or Surveyor, if there are any points of particular importance to you. Reference to the tenure of the property is based on information given to us by the seller, as we will not have had sight of the title documents. You are advised to obtain verification from your Solicitor/Conveyancer. Before viewing a property, do please check with us as to its availability, and also request clarification or information on any points of particular interest to you, to save you any possible wasted journeys. Also, photographs are for illustration only and may depict items which are not for sale or included in the sale of the property. All sizes are approximate, all dimensions include wardrobe space where applicable. While we believe that the area of the property has been accurately calculated, any prospective buyer who considers this feature to be particularly important is strongly recommended to have the site measurements checked by their own surveyor before submitting an offer to purchase.