

**STATONS**

[www.statons.com](http://www.statons.com)

# Musgrave Close

Hadley Wood, EN4





# Musgrave Close Hadley Wood, Hertfordshire, EN4 0LX

AVAILABLE IMMEDIATELY. Set in this desirable cul de sac in the heart of Hadley Wood, this beautifully presented and well appointed detached family home has been recently refurbished to exacting standards. The property benefits from a newly fitted kitchen and bathrooms.

Council Tax Band G  
6 weeks rent deposit

































Energy Efficiency Rating		
	Current	Potential
Very energy efficient - lower running costs		
(92+) <b>A</b>		
(81-91) <b>B</b>		
(69-80) <b>C</b>		
(55-68) <b>D</b>		
(39-54) <b>E</b>		
(21-38) <b>F</b>		
(1-20) <b>G</b>		
Not energy efficient - higher running costs		
<b>England, Scotland &amp; Wales</b>	EU Directive 2002/91/EC	

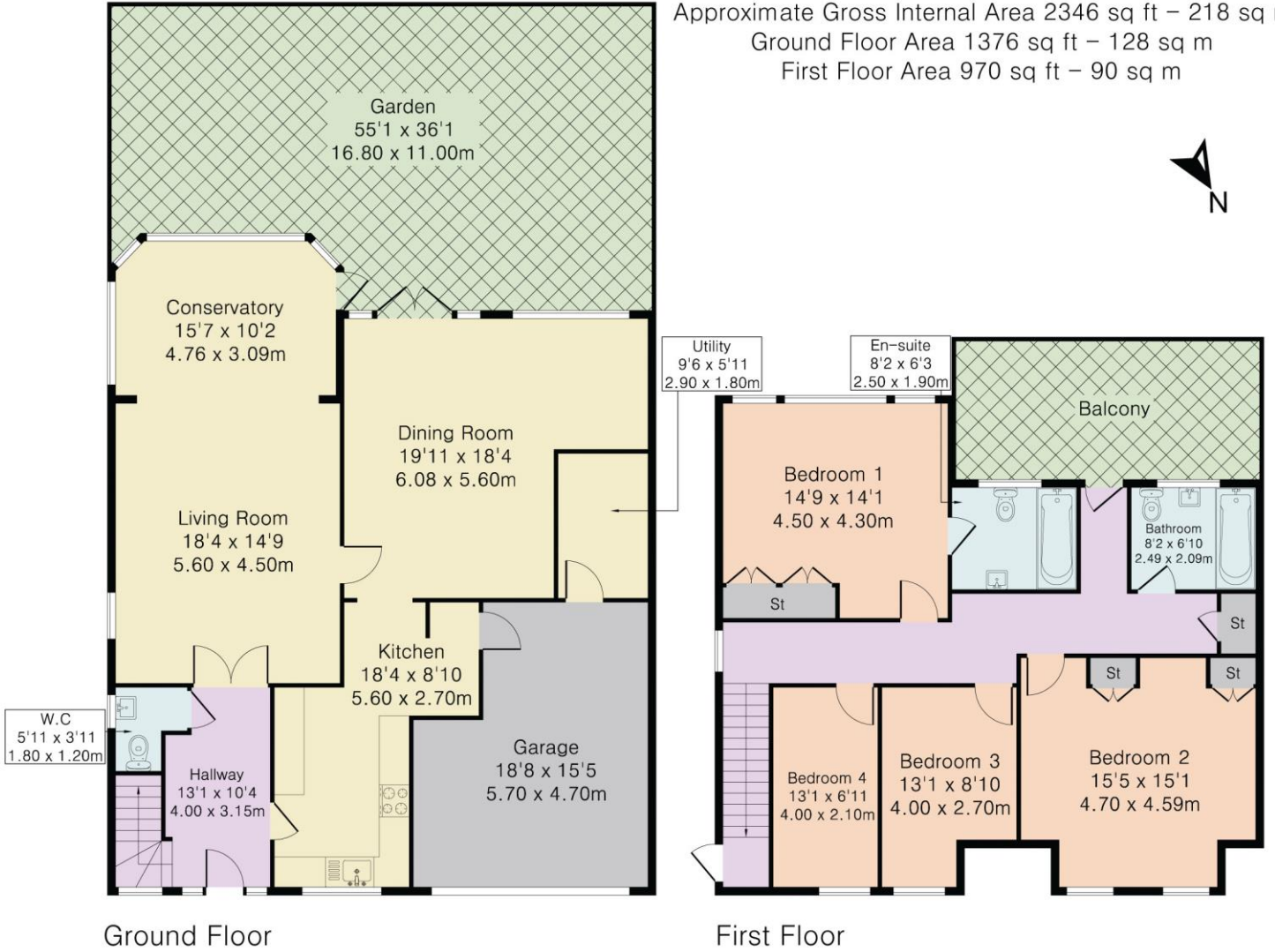





**STATONS**  
**PREMIER LETTINGS**

1/2 Hadley Parade  
Barnet  
HERTS  
EN5 5SX  
020 8441 9796  
[lettings.office@statons.com](mailto:lettings.office@statons.com)