



Church Lane  
Northaw EN6 4NX



# 15 Church Lane, Northaw EN6 4NX

❖ NO ONWARD CHAIN. A one bedroom character cottage situated in the pretty village of Northaw. The property comprises, to the ground floor a stunning lounge, fitted kitchen, study and cloakroom. On the first floor there is a spacious principal bedroom with fitted wardrobes and a lovely bathroom.

❖ The rear garden is circa 90' in length and has been redesigned to create a lovely entertaining decked area to enjoy the southerly aspect.

❖ The property is situated in the pretty village of Northaw, although quietly situated the access to London is excellent with good road and rail connections from Potters Bar and Cuffley Train Stations. Trains to Kings Cross take under 25 minutes from the local station and Junction 24 of the M25 is less than 2 miles away. The area offers a very good selection of state, private and community schools.





























# Church Lane, Northaw, Potters Bar, EN6

Approximate Area = 694 sq ft / 64 sq m (excludes restricted head height)

For identification only - Not to scale



FIRST FLOOR

Denotes restricted head height

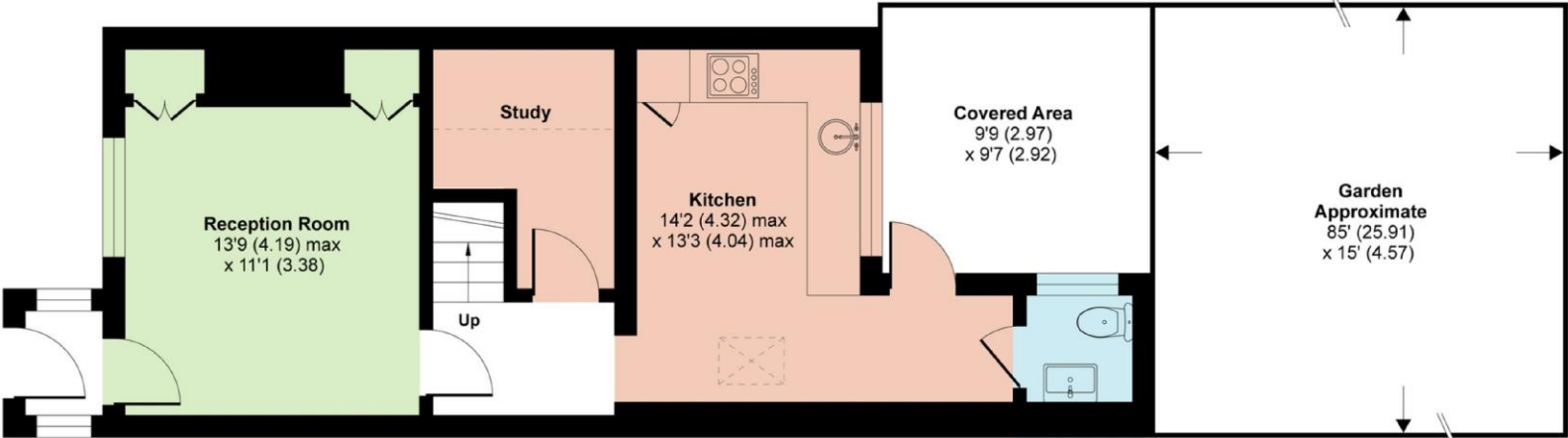
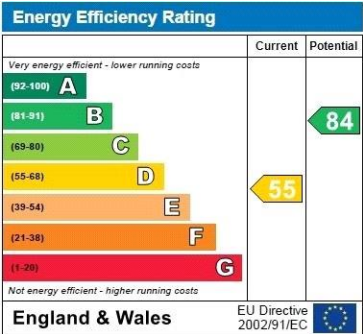

GROUND FLOOR

DISCLAIMER: In accordance with the 1993 Misrepresentation Act the agent had not tested any apparatus, equipment, fixtures, fittings or services and so, cannot verify they are in working order, or fit for their purpose. Neither has the agent checked the legal documentation to verify the leasehold/freehold status of the property. The buyer is advised to obtain verification from their solicitor or surveyor. Also, photographs are for illustration only and may depict items which are not for sale or included in the sale of the property. All sizes are approximate. All dimensions include wardrobe spaces where applicable.

Local Authority:  
Welwyn & Hatfield Borough Council  
Council Tax Band: E  
FREEHOLD





Brookmans  
Park Office

53 Bradmore Green, Brookmans Park, Herts, AL9 7QS

T: 01707 661144

E: [brookmans@statons.com](mailto:brookmans@statons.com)

**STATONS**  
[www.statons.com](http://www.statons.com)