

**Rolfe Close**  
Barnet



## Rolfe Close, Barnet, EN4 9QU

**NO ONWARD CHAIN.** Situated in the sought-after Rolfe Close this two/three bedroom detached bungalow offering versatile single-storey living, ideal for a range of buyers.

The property is approached via off-street parking and benefits from an attached garage, providing excellent storage and practicality. Internally, the accommodation is arranged around a central hallway, creating a well-balanced and functional layout throughout.

To the front of the property is a bright and welcoming living room, offering an ideal space for relaxing and entertaining. The separate kitchen is positioned to the rear and provides direct access to the garden, alongside a useful utility area.

The bungalow further comprises two well-proportioned bedrooms, a family bathroom, and a separate dining room which offers flexibility for use as a further bedroom.

To the rear, the property enjoys a generous private garden circa 65' in length, providing excellent outdoor space for families, entertaining, or gardening enthusiasts.

Rolfe Close is conveniently located for local amenities, transport links, and green open spaces, making this an excellent opportunity to acquire a detached bungalow in a desirable Barnet location.





STATONS



STATONS







**STATONS**



**STATONS**



STATONS





**STATONS**

Approximate Gross Internal Area 1139 sq ft - 106 sq m  
(Including Garage)

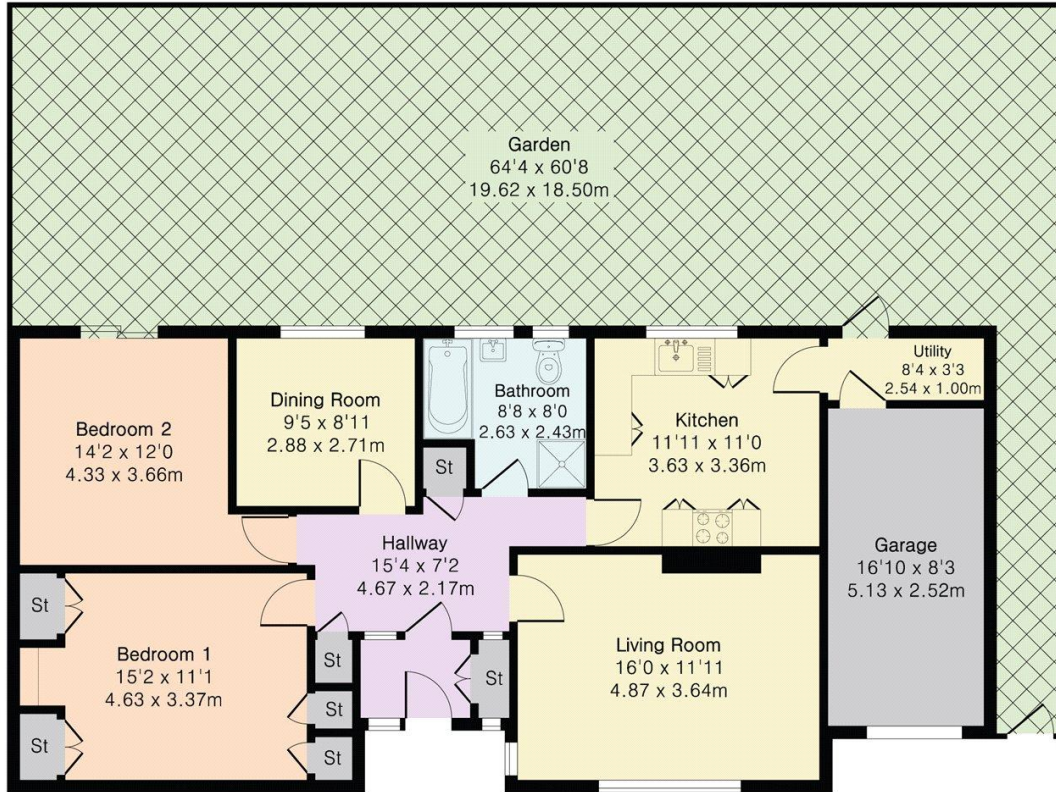

Ground Floor



Floor plan produced in accordance with RICS Property Measurement 2nd Edition. Although Pink Plan Ltd ensures the highest level of accuracy, measurements of doors, windows and rooms are approximate and no responsibility is taken for error, omission or misstatement. These plans are for representation purposes only and no guarantee is given on the total square footage of the property within this plan. The figure icon is for initial guidance only and should not be relied on as a basis of valuation.



Local Authority: Barnet  
Council Tax band: F  
Tenure: Freehold

DISCLAIMER: In accordance with the 1993 Misrepresentation Act the agent had not tested any apparatus, equipment, fixtures, fittings or services and so, cannot verify they are in working order, or fit for their purpose. Neither has the agent checked the legal documentation to verify the leasehold/freehold status of the property. The buyer is advised to obtain verification from their solicitor or surveyor. Also, photographs are for illustration only and may depict items which are not for sale or included in the sale of the property, All sizes are approximate. All dimensions include wardrobe spaces where applicable.

# STATONS

[www.statons.com](http://www.statons.com)

## STATONS BARNET

1 HADLEY PARADE  
HIGH STREET  
BARNET  
HERTS  
EN5 5SX  
020 8449 3383  
[barnet@statons.com](mailto:barnet@statons.com)



# STATONS